

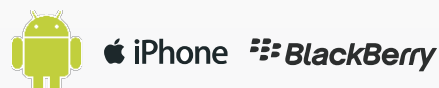

FA001BH

Support :



Key Features

- IR LED: ϕ 5x72PCS IR range: 60M
- 2.8-12mm Manual Zoom Lens (2M Pixels)
- Water resistance: IP66 3-Axis Cable built-in bracket
- DC 12V/AC24V double voltage add USD4
- Size: 240(W)x186(H)x100(D)mm

CONNECTION

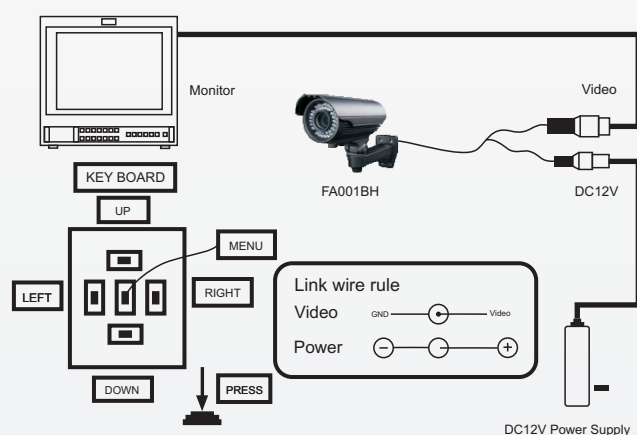

FA001BH Analog CCTV Camera

Image Sensor	1/3" HDIS 800TVL, With IR-CUT CMOS
Lens	2.8-12mm Manual Zoom Lens (2M pixels)
Electronic Shutter	Auto: PAL 1/50-1/100,000Sec; NTSC 1/60-1/100,000Sec
TV System	PAL / NTSC
Horizontal Resolution	800TV Lines Low Illumination DWDR, OSD (DNR, PM, MD)
Effective Pixel	720(H)x576(V)
IR Distance	IR LED: ϕ 5 x 27PCS 60 Meter
IR Status	Under 10 Lux By CDS
IR Power ON	CDS Auto Control
Usable Illumination	0.001 Lux/F1.2
S/N Ratio	\geq 48dB (AGC OFF)
Power	DC12V \pm 10%, 1000mA
Temperature	-10°C ~ +50°C Rh95% MAX
Ready Use	Outdoor
Others	Vandalproof Housing IP66